



RACK CONVEYOR DISHWASHER SRC-2700

100/150 baskets per hour (up to 2.700 plates/hour)



WARE WASHING
RACK CONVEYOR DISHWASHERS



SALES DESCRIPTION

Washing + rinsing.
2 speeds.

FEATURES AND BENEFITS

- ✓ Fully stainless steel jacket.
- ✓ Inlet and outlet splash guards are standard.
- ✓ Stainless steel central rack feed system.
- ✓ Process cycles are divided by rubber curtains.
- ✓ Automatic cycle start.

Economy

- ✓ Energy saving rinse supply switch.
- ✓ Pressure controller in the rinse section to limit consumption.
- ✓ Programmed automatic stops if there is no loading.
- ✓ Stop and freezing of timer when the limit switch actuates.

Cleaning and maintenance

- ✓ Wide pivoting door allowing access for cleaning or inspection purpose.
- ✓ Detachable arms and dispersers for easier cleaning.
- ✓ Sloped removable stainless steel filters with independent removable basket.
- ✓ Easy boiler emptying by loosening a hose.
- ✓ Failures are easily detected thanks to the warning lights.
- ✓ Easy to repair without moving the machine.

Washing

- ✓ Stainless steel wash arms and deep-drawn dispersers.
- ✓ Efficient and durable wash arm dispersers.
- ✓ Powerful, self-draining vertical wash pump.
- ✓ Easy to install detergent dispenser intake in washing tank.

Rinsing

- ✓ Stainless steel rinse arms and powerful, stainless steel, deep-drawn dispersers.
- ✓ Automatic boiler filling with no failure risk for heating elements.
- ✓ Temperature control with high precision probes.
- ✓ Visualisation and adjustment of washing and rinsing temperatures in the digital display by pressing a button.
- ✓ Easy to install rinse aid dispenser intake in boiler.

INCLUDES

- ✓ Inlet and outlet splash guards are standard.



www.sammic.co.uk

Food Service Equipment Manufacturer

Unit 2, Trevanth Road
Troon Industrial Park
LE4 9LS - Leicester

uksales@sammic.com
Tel.: +44 0116 246 1900



Project

Date

Item

Qty

Approved

product sheet
updated 06/03/2018



RACK CONVEYOR DISHWASHER SRC-2700

100/150 baskets per hour (up to 2.700 plates/hour)



SPECIFICATIONS

Production

- ✓ Production baskets/hour: 100 / 150
- ✓ Production plates/hour: 1800 / 2700

Wash

- ✓ Temperature: 55 °C - 65 °C
- ✓ Wash tank capacity: 100 l
- ✓ Pump: 3.2 Hp / 2400 W
- ✓ [s:1av_resist]: 9000 W

Rinse

- ✓ Temperature: 80 °C - 90 °C
- ✓ Water consumption: 330 l/h
- ✓ Rinse heating element: 18000 W
- ✓ Boiler capacity: -- l

Drag

- ✓ Drag motor power: 0.25 Hp / 135 W

Loading

- ✓ Central module total power : 29535 W

External dimensions (WxDxH)

- ✓ Width: 1700 mm
- ✓ Depth: 829 mm
- ✓ Height: 1520 mm

Net weight: 250 Kg

Water Intake: 3/4 "

Drain diameter: 1 1/2 "

Noise level (1m.): 71 dB(A)

Optional accessories

- ✓ Drying unit: TS-600
- ✓ Extraction systems: CA/EV/CV
- ✓ Tables

Please note: +3kW rinse heating element in models equipped with steam condenser.

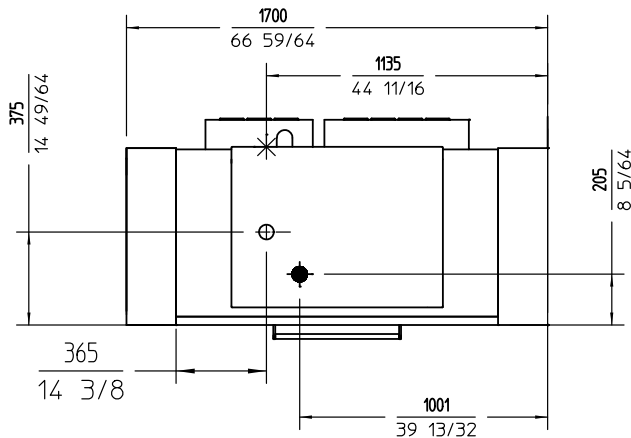
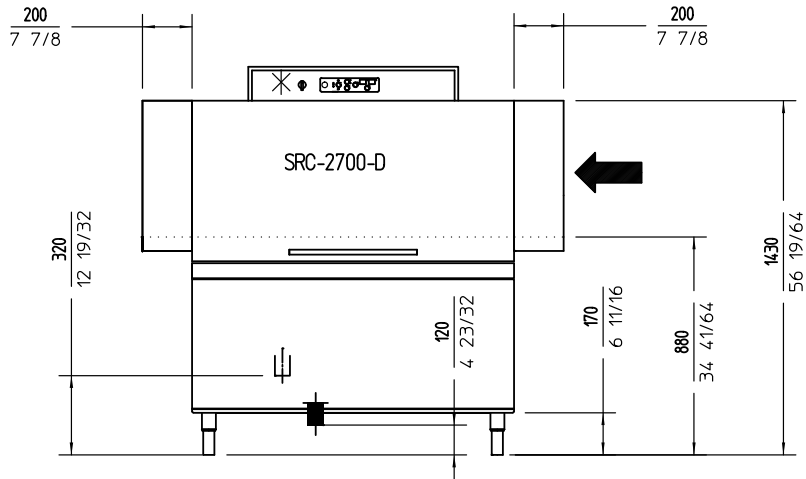

AVAILABLE MODELS

1302550 Dishwasher SRC-2700D 400/50/3N (right hand entry)

1302563 Dishwasher SRC-2700I 400/50/3N (left hand entry)

* Ask for special versions availability

ACCESSORIES

- Drying units
- Manual water softeners
- Automatic water softeners
- 500 x 500 mm. baskets
- Inserts, supplements & similar
- Loading table for corner situation for rack conveyor dishwashers
- Central sorting tables
- Double connection central sorting table
- Single exit tables
- Roller conveyor and corner roller conveyor
- Machined curve
- CA Extraction hood
- EV Extraction hood with motor
- CV Extraction hood with steam condensation
- Connecting tables for Pass-Through dishwashers and rack conveyors
- Drying unit for corner situation

WARE WASHING
RACK CONVEYOR DISHWASHERS



www.sammic.co.uk

Food Service Equipment Manufacturer

Unit 2, Trevanah Road
Troon Industrial Park
LE4 9LS - Leicester

uksales@sammic.com
Tel.: +44 0116 246 1900



Project

Date

Item

Qty

Approved

product sheet
updated 06/03/2018