

# Assembly

200kg 2x20GN 1/1 lengthwise

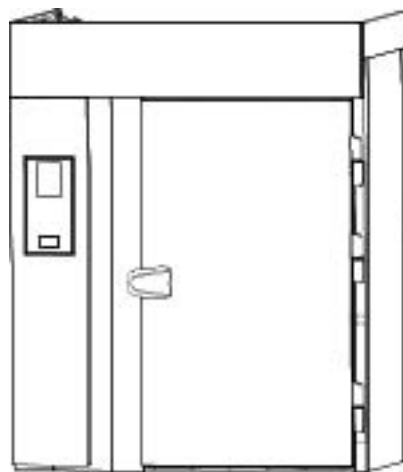

---

EN            Instruction \*



\*Original instructions

595R49000- 2021.03

## Important notice

This manual is intended for technical personnel specialised in the installation of refrigeration equipment, and provides all the information necessary for correct installation of the disassembled blast chiller..

**Read these instructions carefully before carrying out any operation.**



### **IMPORTANT**

- The manufacturer declines any liability for operations carried out on the appliance without respecting the instructions given in this manual.
- The manufacturer reserves the right to modify the appliances presented in this publication without notice.
- The manufacturer declines any liability for improper use of the product.
- No part of this manual may be reproduced.

## Contents

A	WARNING AND SAFETY INFORMATION.....	4
A.1	General information .....	4
A.2	Installation and assembly .....	4
B	KIT CONTENTS .....	5
B.1	Screws and small parts.....	5
C	ASSEMBLY .....	6
C.1	Introduction .....	6
C.2	Positioning .....	6
C.3	Assembly instructions.....	7
	C.3.1 Automatic draining .....	13

---

## A WARNING AND SAFETY INFORMATION

---

### A.1 General information

To ensure safe use of the machine and a proper understanding of the manual it is necessary to be familiar with the terms and typographical conventions used in the documentation. The following symbols are used in the manual to indicate and identify the various types of hazards:



#### **WARNING**

Danger for the health and safety of operators.



#### **WARNING**

Danger of electrocution - dangerous voltage.



#### **CAUTION**

Risk of damage to the machine or the product.



#### **IMPORTANT**

Important instructions or information on the product



Equipotentiality



Read the instructions before using the appliance



Clarifications and explanations

### A.2 Installation and assembly

- Machine installation and assembly operations must only be carried out by specialised personnel provided with all the appropriate personal protection equipment, tools, utensils and ancillary means, with adequate enclosure of the assembly area to keep out unauthorised persons.
- The operations described must be carried out in compliance with the current safety regulations.
- Disconnect the appliance from the power supply before carrying out any installation and assembly procedure.
- Install the appliance, taking all the safety precautions required for this type of operation, also respecting the relevant fire-prevention measures.
- For models without incorporated refrigerating system, the connection pipes must be arranged in order to access the back of the appliance for maintenance. (see the Service Manual on the web site).
- For the choice of remote condensing unit refer to the unit recommended by the Manufacturer, given on the equipment technical sheet.
- In case of extraordinary size of the remote condensing unit refer to the technical sheet for the refrigeration capacity data or consult the Manufacturer's website or Local Service Center/ Agency authorized by the Manufacturer.
- Installation of the appliance and the refrigerant fluid condensing unit must only be carried out by the manufacturer's service personnel or by specialised personnel.

- The connection to the electrical power supply must be carried out in compliance with the current regulations.
- The information regarding the appliance power supply voltage is given on the dataplate.
- Carry out the electrical connection according to the enclosed electrical wiring diagram.

**For further details, see the instruction manual (Quick Guide) provided with the appliance or the complete installation and user manual on the web site.**

## B KIT CONTENTS

The kit contains everything necessary for installing the blast chiller. To avoid damage during transport, some parts are shipped pre assembled.

### B.1 Screws and small parts

- Buffer fixing (M5x12 – M6x12)



- Compartment bottom fixing (M6x12)



- Right/left side panel fixing (4,2x13)



- Top shims

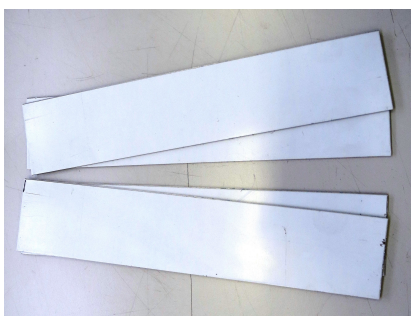

- Resistance protection fixing (4,2x13)



- Water drain pipe



- Ties for evaporator and electrical system, plastic plug

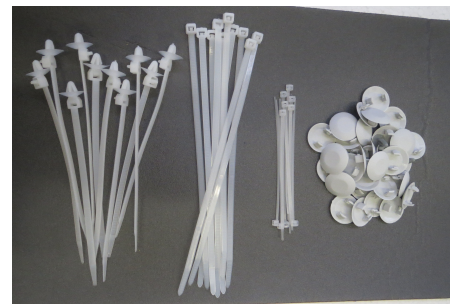

- Probe support bracket fixing

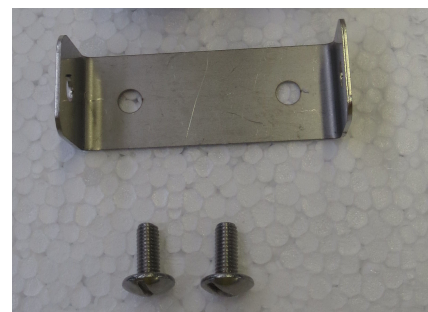

- Splash guard fixing (M5x12)



- Cable protection fixing with screws M5x12



- Terminal kit (optional)

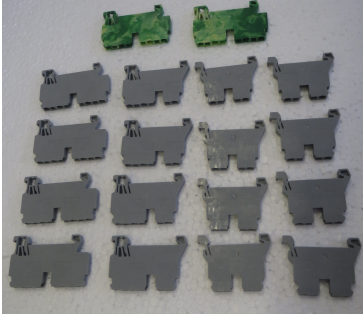

## C ASSEMBLY

### C.1 Introduction



#### WARNING

Use suitable protection equipment (protective gloves) when installing the machine. The manufacturer declines any liability if the following operations are not carried out as described.

### C.2 Positioning



#### NOTE!

To correctly carry out installation, some pre-assembled parts must be disassembled (for example the complete evaporating unit assembly and the complete refrigerating unit).

- Remove the parts from the box.
- To simplify installation operations, it is advisable to assemble the cabinet body in a horizontal position.
- Use an M8 allen key to operate on the couplings. The coupling has a cam mechanism that pushes out the catch and then draws it back to secure the panels.

### PANEL ASSEMBLY SCHEME

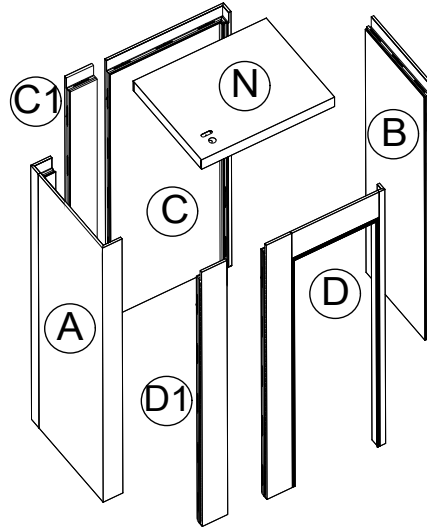

A	Left side
B	Right side
C/C1	Back
D	Front panel with door opening
D1	Front panel
N	Top



#### IMPORTANT

Before positioning the panels on the floor, make sure to place a sheet of cardboard larger than the area of the panels on the floor in order to protect them.

### C.3 Assembly instructions

1. Take the left side and fit the splash guards (1-2);

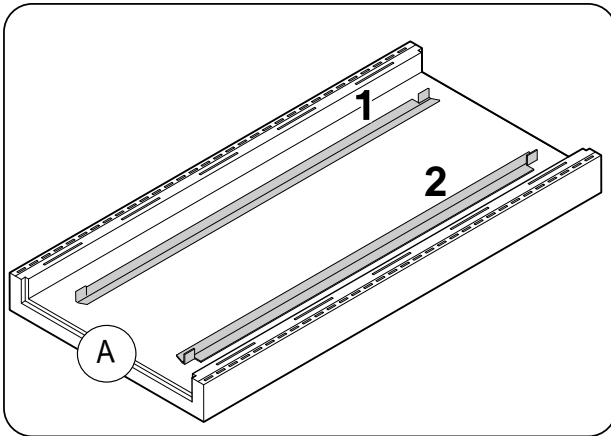

2. Take the backs C and C1 and join them by closing the catches.

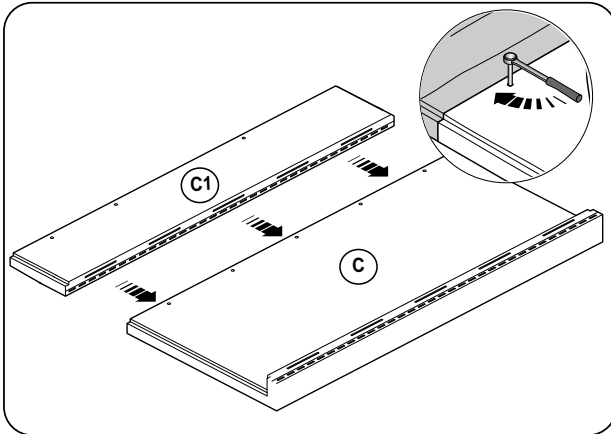

3. Take the back, position the left side and close the couplings. A CLICK must be heard! Do not use excessive force in closing operations.

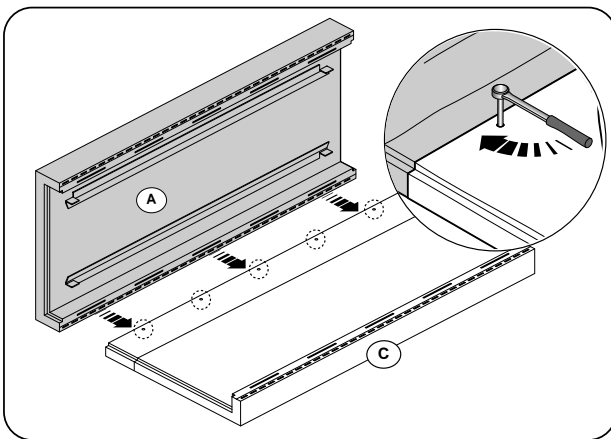

4. Repeat the same operation for the right side.

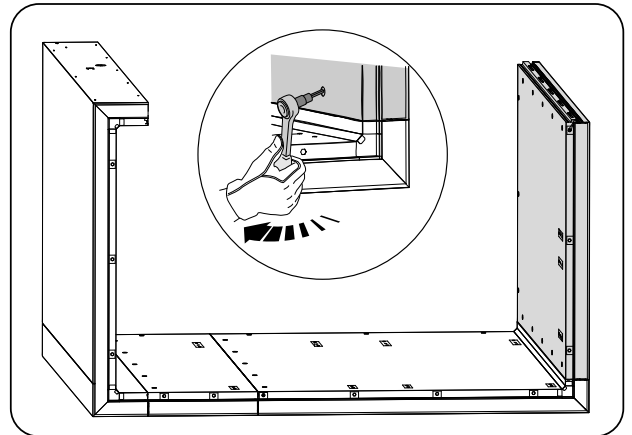
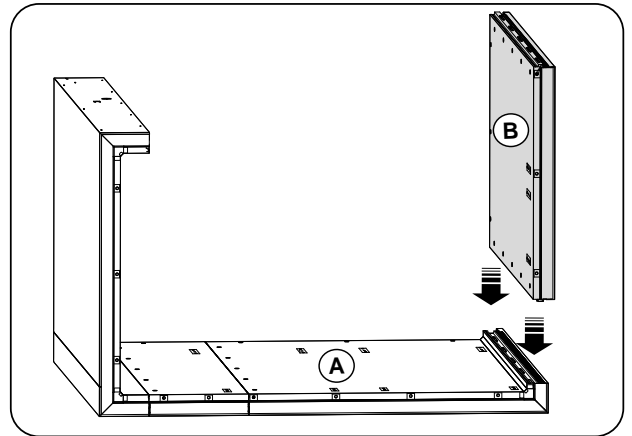

5. Close all coupling holes and the others with the plugs supplied after removing the protective film.

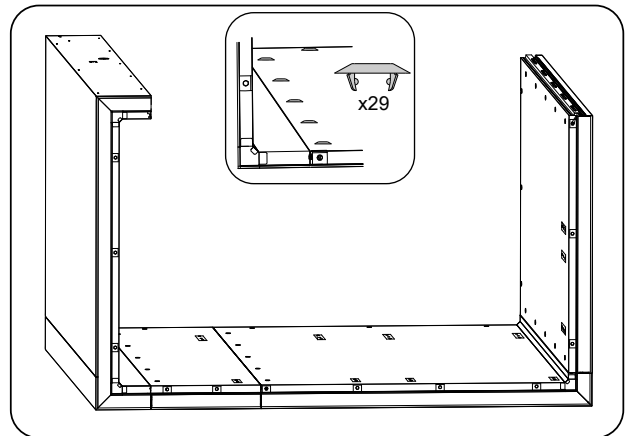

6. Take the front panel D1 and the front panel with door opening D and join them by closing the catches.

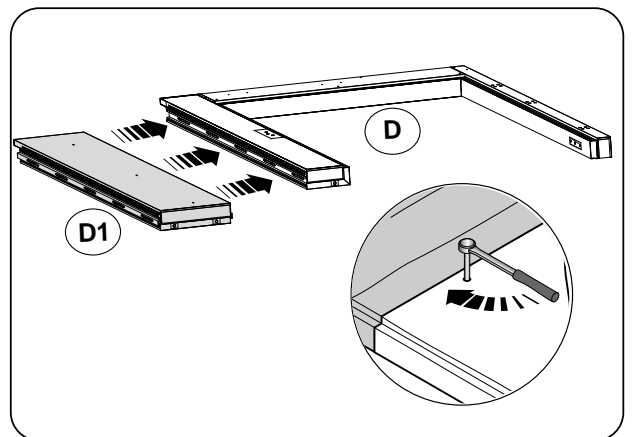

7. Join the front panel with door opening with the back and sides.

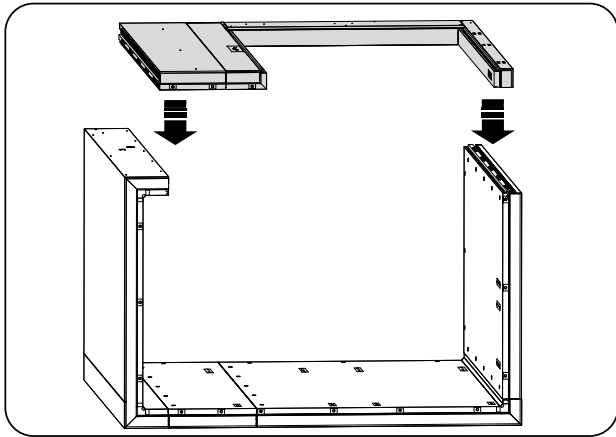

8. Place 2 shims (A-B) on the lower part. Join the top to the other panels, starting from the bottom (1). Insert 2 shims on the upper side (C-D) and join the upper part of the top to the other panels (2). Close the clips inside the appliance.

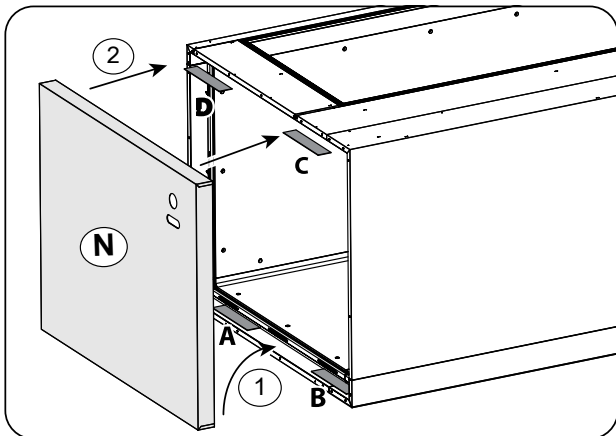

9. Silicone the entire perimeter of the top.

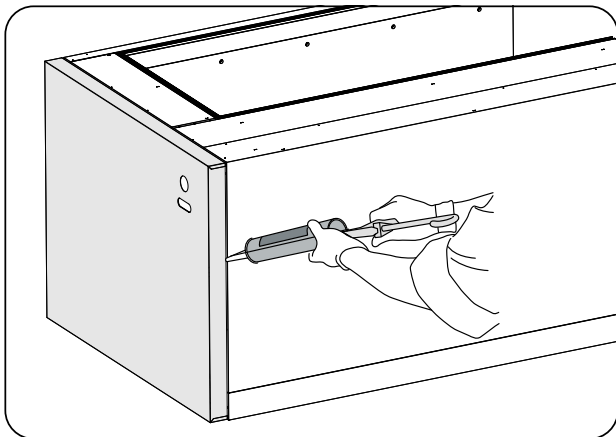

10. Run the heating cables (R1/2) along the cabinet trim, making them come out the hole provided on the front panel.

Secure the hot cables cover with an M 4.8x2 screw.

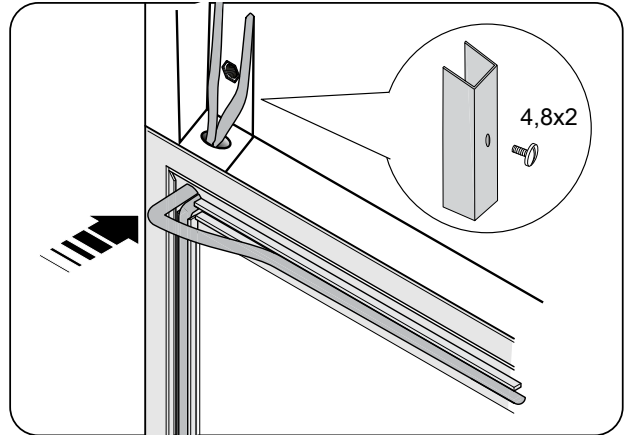

11. Position an anti-condensation cable (R8) on the front panel and fix the cable covering with 8 screws 4.2x13.

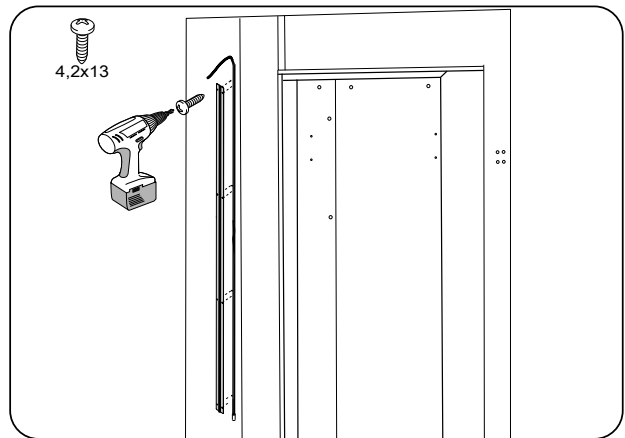

12. Then insert metal stops.

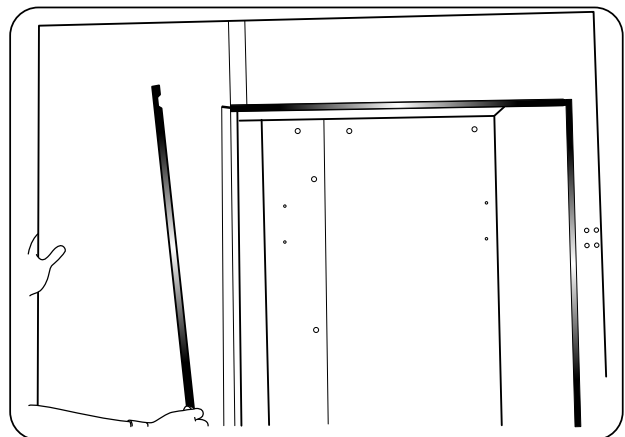



13. Turn the box as shown in figure.

Screw the 2 pins with 8 $\emptyset$  (for evaporator centring) in the threaded bushings of the top (inner side of compartment in AISI 304) located near the 4 through holes (13 $\emptyset$ ).

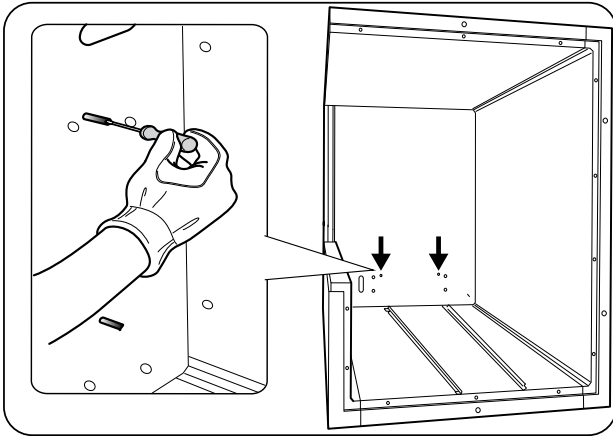

14. Take the evaporating unit, remove the side deflectors and the casing comprising the fans; position the evaporator in the cabinet body.

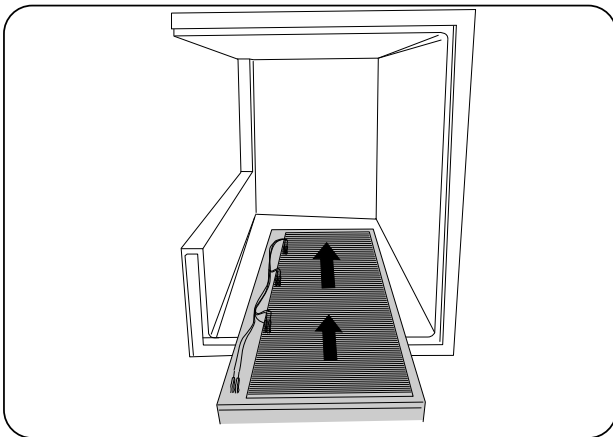

15. Pass the pipes through the slotted opening.

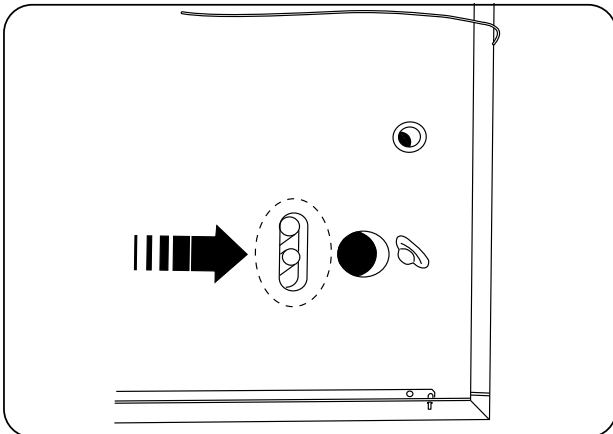

16. Keep as a reference the 2 centring holes with the pins of the top.

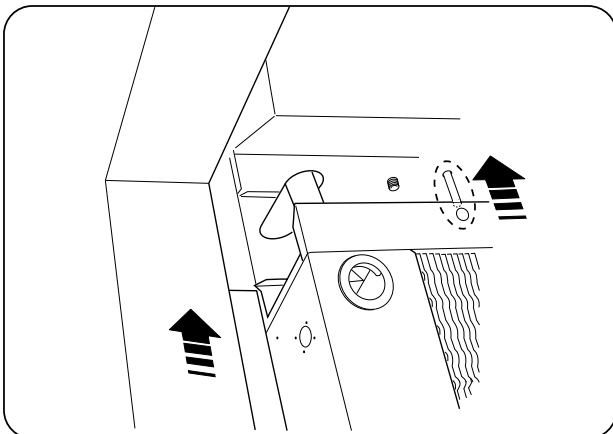

17. Fix the evaporator to the cabinet body, inserting the 4 M8x100 screws from the top.

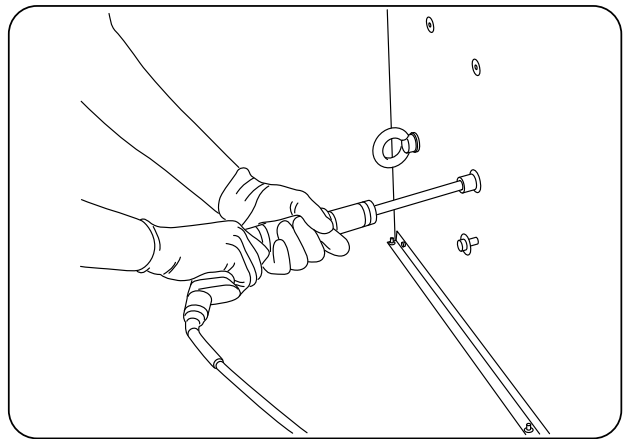

18. Fix the condensate tray to the lower inside back of the evaporator.

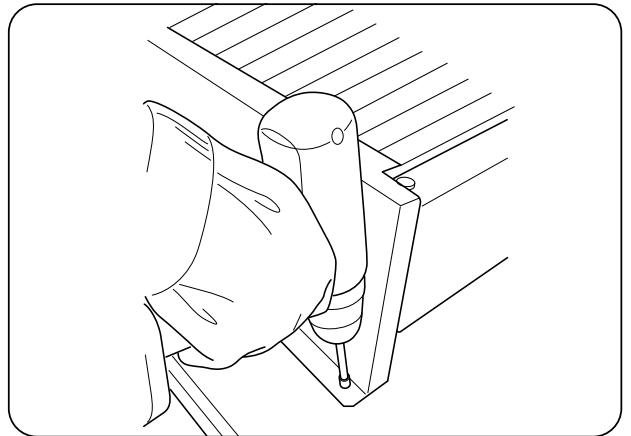

19. Take the casing with fans and insert it on the evaporating unit hinges.

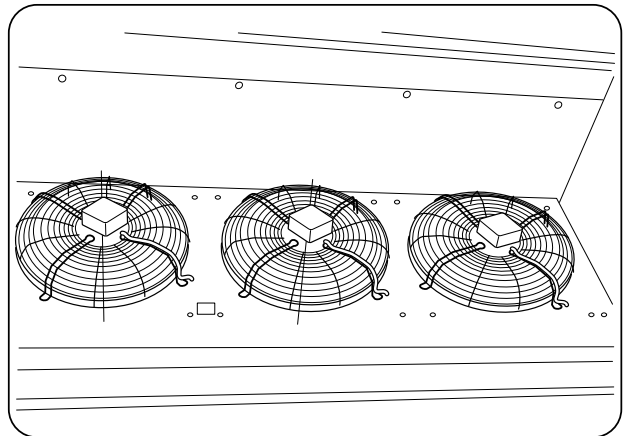

20. Close the bracket

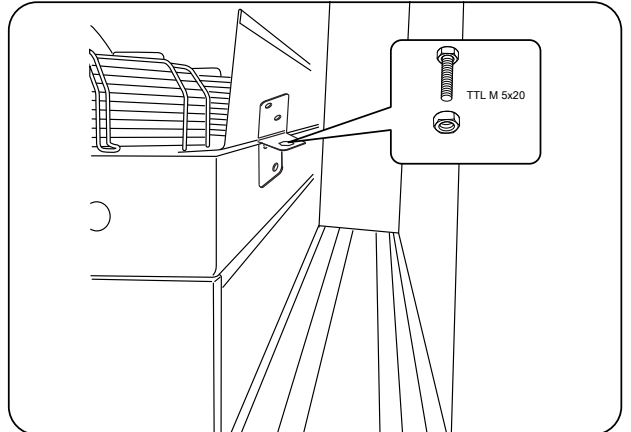

21. Apply the seal around the edge of the panels on which the bottom will be placed and fix the bottom to the panels with M6x16 screws.

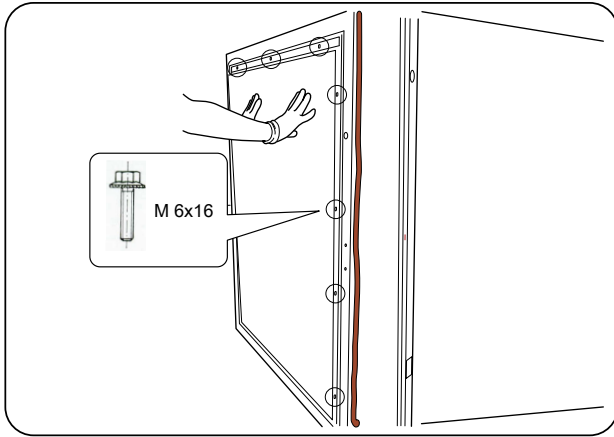

22. Take the door and remove the covers and shims from the hinges.

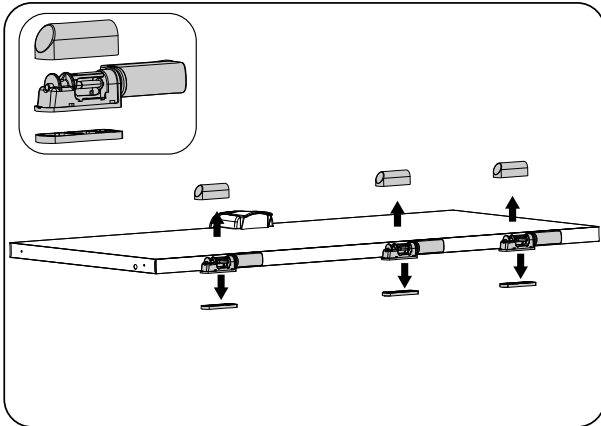

23. Place the door against the cabinet after positioning the hinge shims.

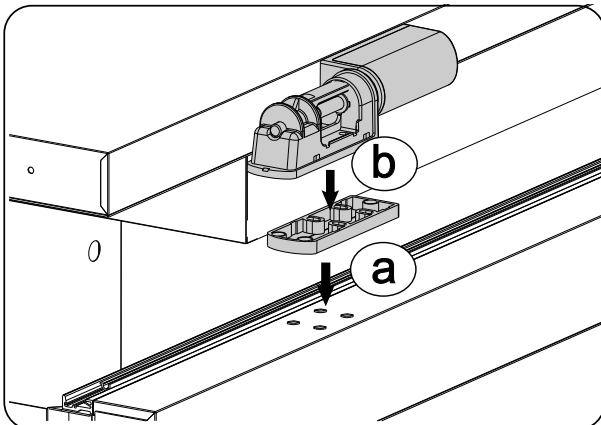
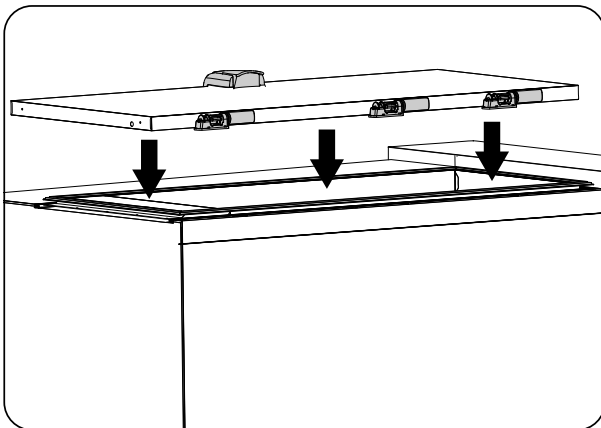

24. Fix the hinges to the cabinet with M6x35 screws.

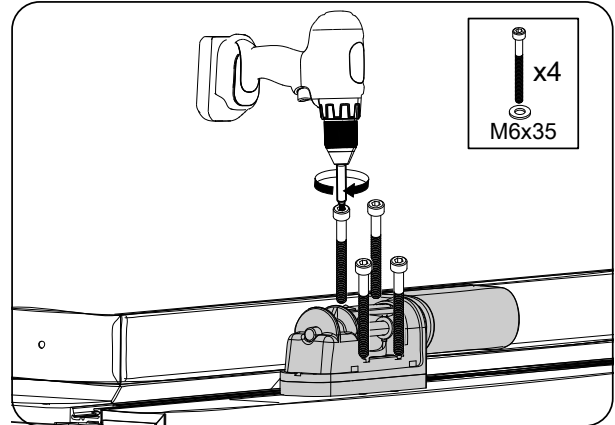

25. Cover the hinges with the special covers.

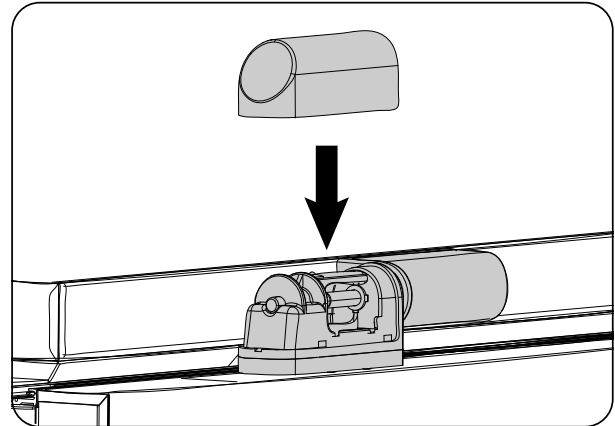

26. Adjust the latch (on the left side of the appliance) for proper support of the door seal.

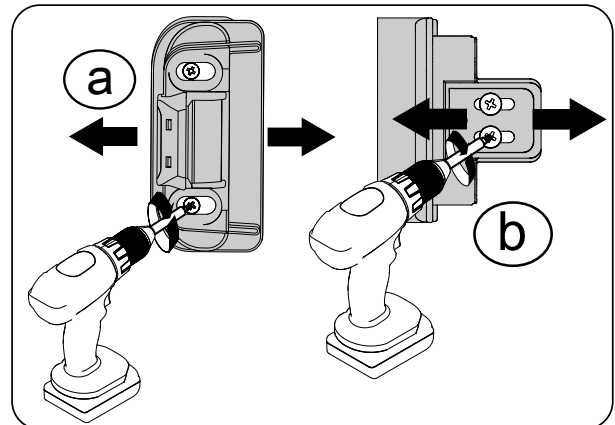
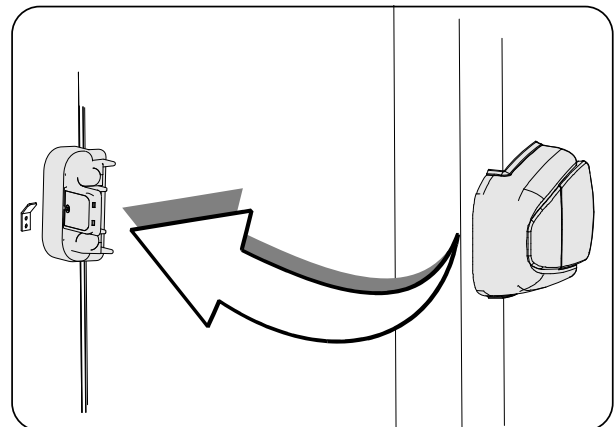

**!** **IMPORTANT**  
After adjusting the closure of the lock, check that the force exerted on the internal opening button is less than 70N (7kgf).

27. Stand the blast chiller up, using the eyebolts located on the top.

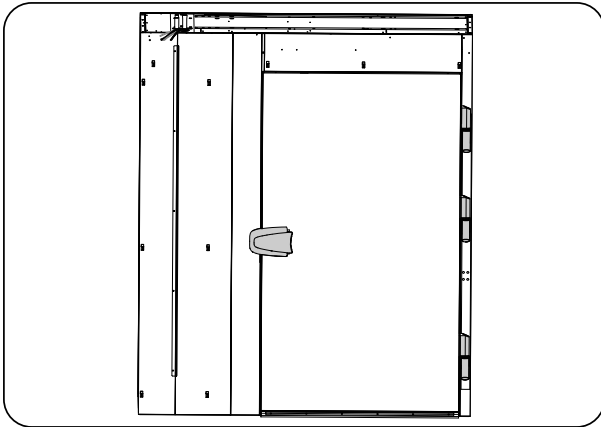

28. Fix the trolley buffers with M5 screws as follows: 1 buffer on the right side, 2 on the back and 2 on the left side.

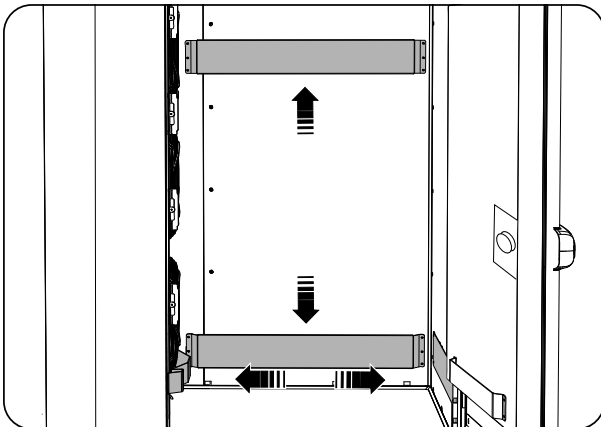

29. Fix the fan cables to the side of the evaporator with the clamps supplied. Run the cables of the two probes (compartment probe and evaporator probe, located respectively on the grille of the first fan at the top, and the other in the upper zone of the finned pack, through the hole arranged in the top.

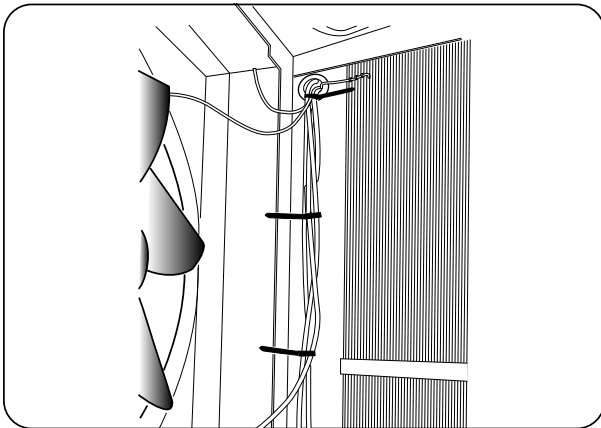

30. Then fix the cable protection inside.

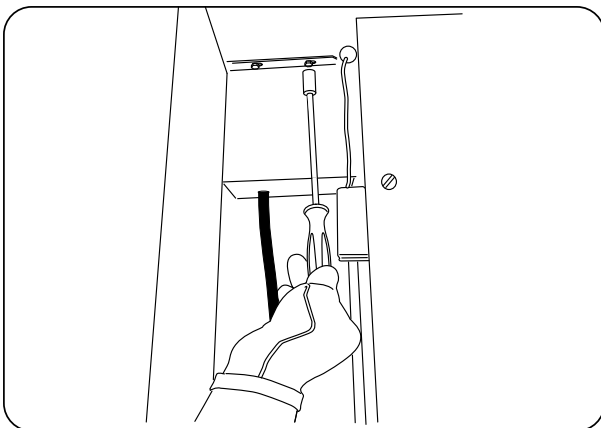

31. Fix the core probe support on the front panel near the air deflector with 2 M5x12 screws.

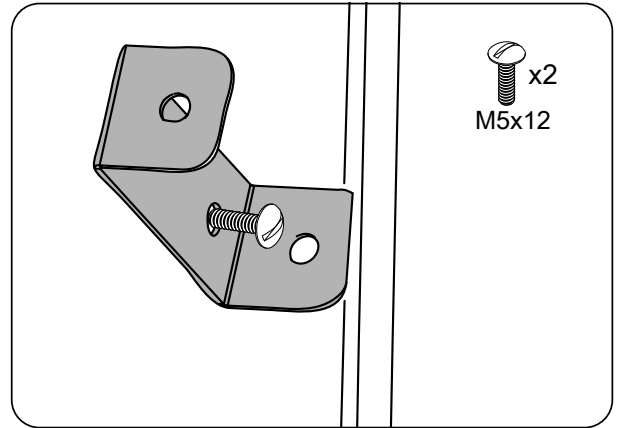

**CAUTION**

The unhooked core probe must not touch the bottom.

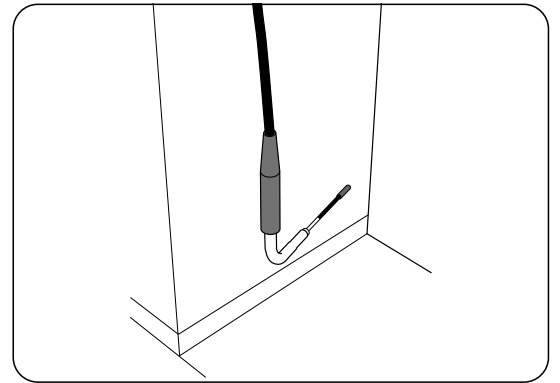

32. Fix the evaporator deflectors.

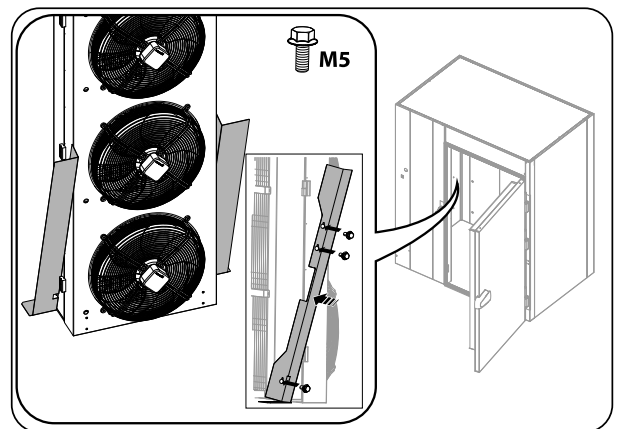

33. Position the pipes with thermostatic valve on the top of the cabinet.

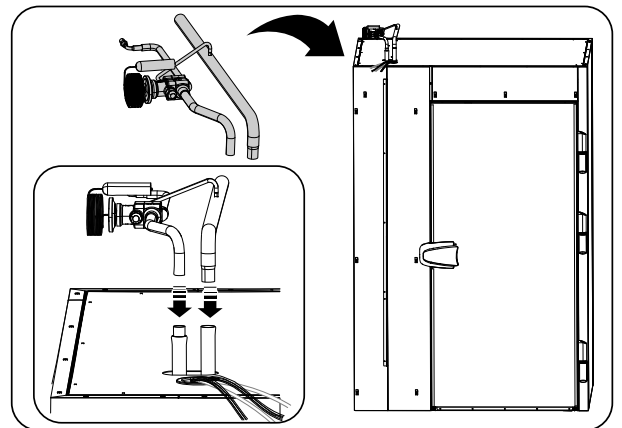

34. Position the unit delivery and return pipes on the evaporator outlet pipes and weld them (before welding the pipes, it is advisable to wrap the thermostatic valve with a damp cloth). Cover the pipes and thermostatic valve with anti condensation tube and seal the top outlet pipes with sealant, covering any join grooves.

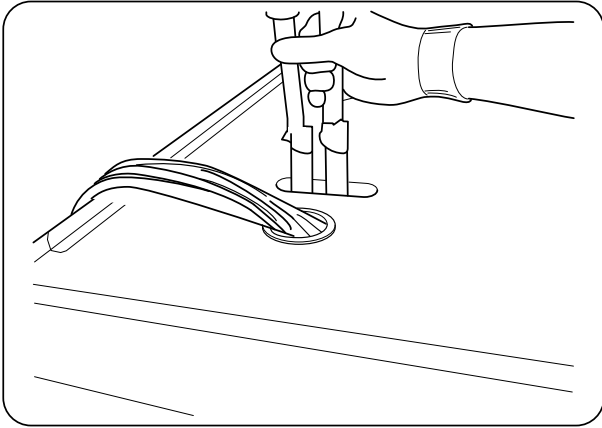

### WARNING

For line evacuation and charging operations, carefully read the instructions in the service manual.

35. Position the electrical system box on the cabinet top.

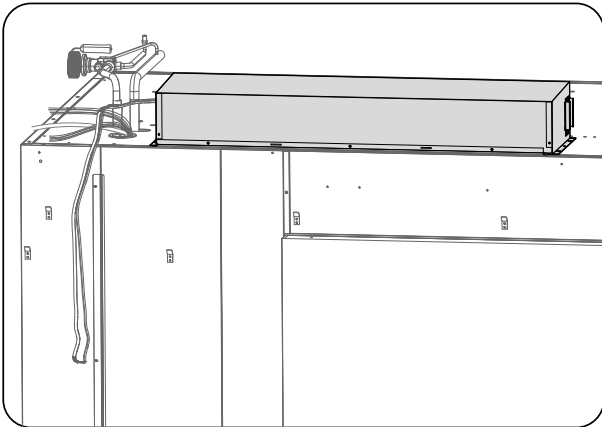

36. Remove the cover of the electrical box

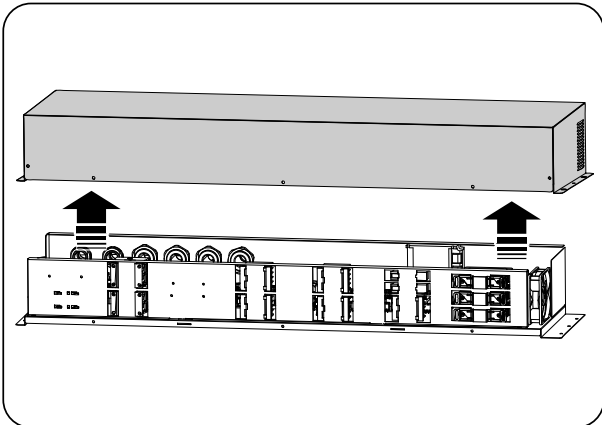

37. Fix it with 4 screws (4.2x13 + toothed washer).

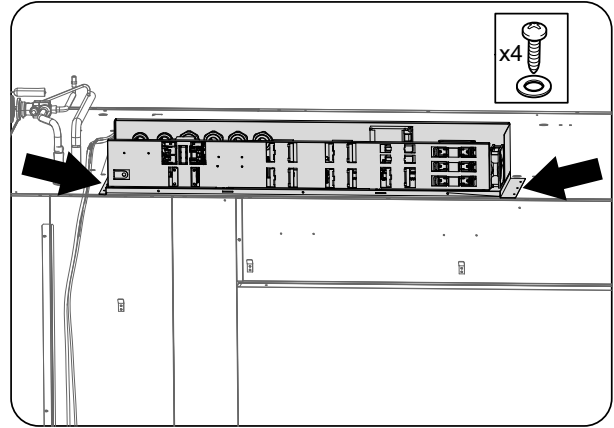

38. Open the additional component panel.

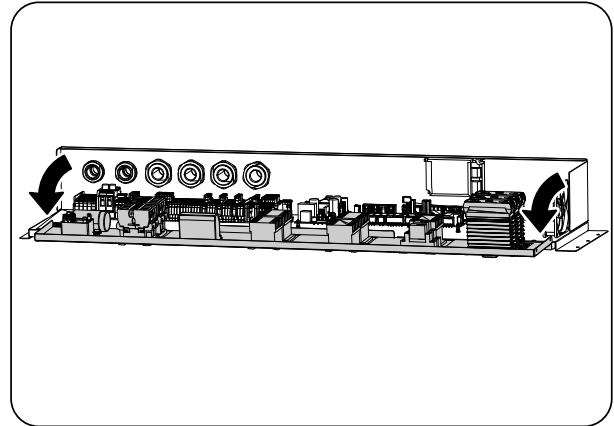

39. Run the cables, coming from the compartment, on the hole arranged in electrical system box. Close the hole with a sealant, making sure to cover any gaps.

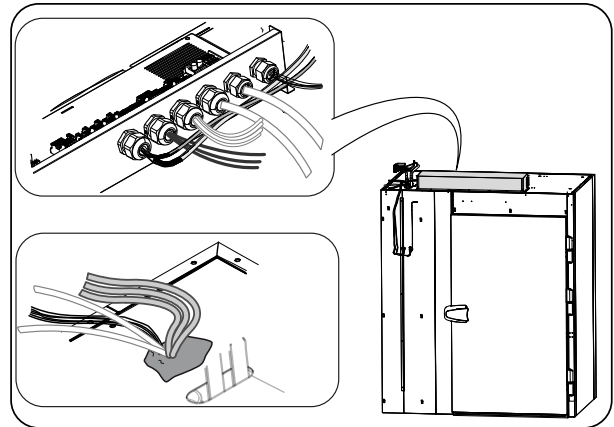

40. Connect all the cables, including those from the compartment, to the terminal block, carefully following the numbering given on them and the wiring diagrams.

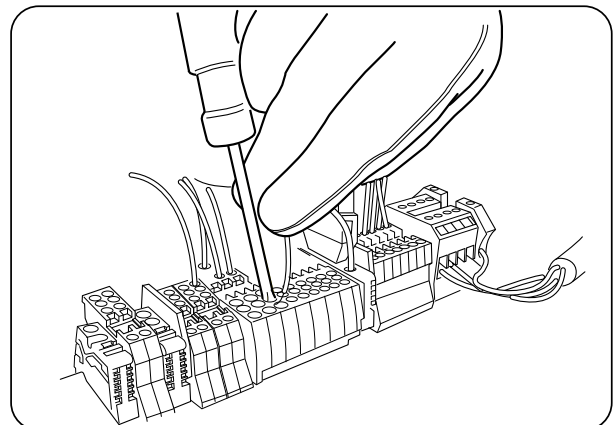

41. Close the additional component panel and fix the cover of the electrical box with 2 screws (4.2x13).

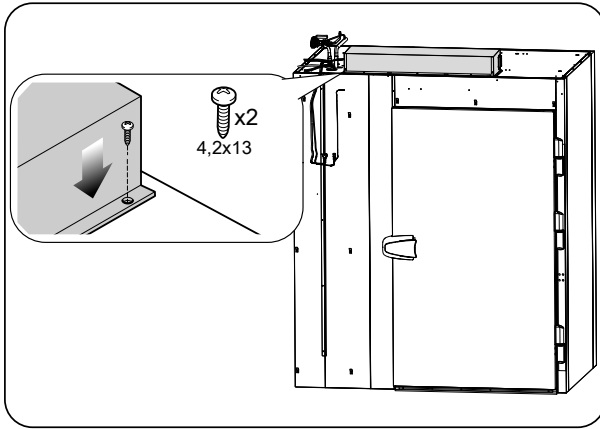

42. Fit the right and left side panels, fixing them with the appropriate screws (M4.2x13).

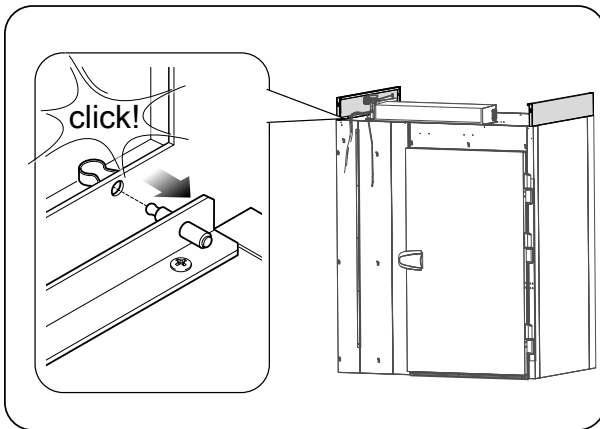
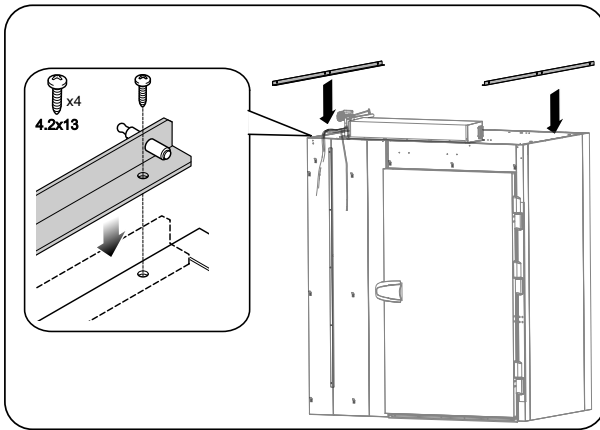

43. Connect the "USER" board power cable and the earth wire to the control panel.

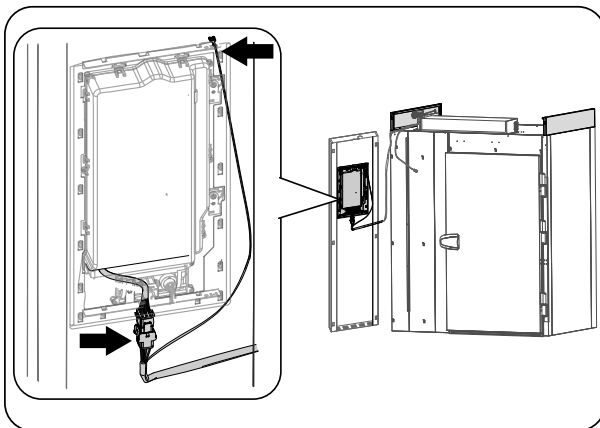

44. Hook the control panel to the support brackets.

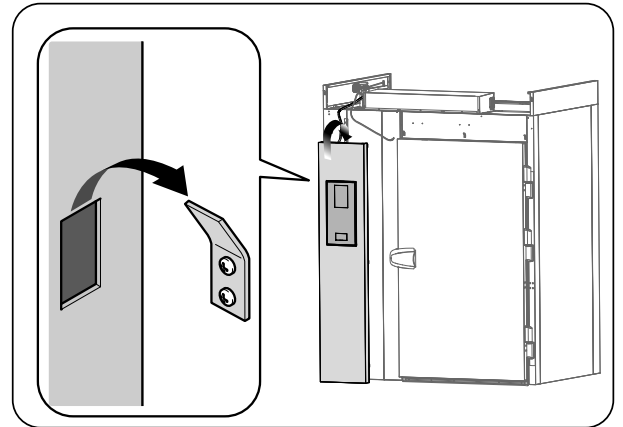

45. Connect the door micro switch wire to the neutral front panel.

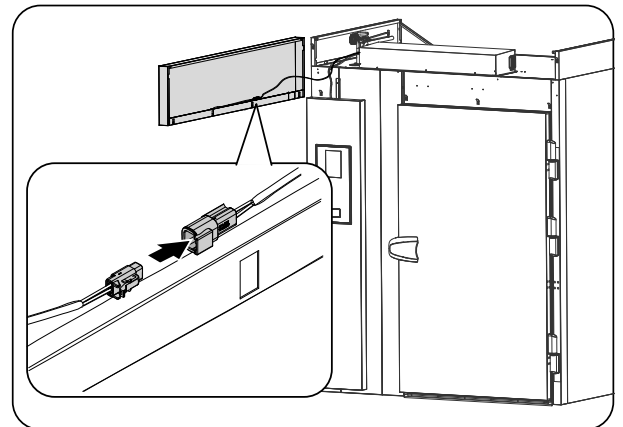

46. Hook the neutral front panel to the support brackets and fix it to the right and left side panels with screws M4.2x13.

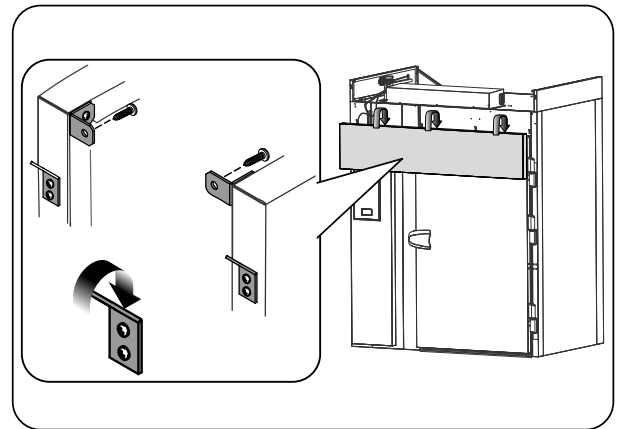

47. Fit the rear brackets with four 4.8x13 large head screws.

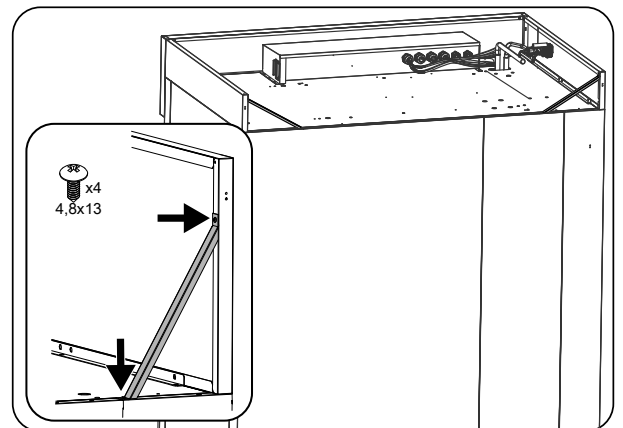

### C.3.1 Automatic draining

Connect the compartment drain "D", located on the evaporator tray, to a drainage system using the special accessories supplied (bend, fitting, steel pipe), choosing the most suitable

side for draining the condensate. It is advisable to use a floor grate.

The drain diameter is  $\frac{3}{4}$ ". Emptying must occur through a trap into an open drain, to prevent any backflow from the drainage system reaching the internal pipes of the equipment. Make sure there are no restrictions in the flexible pipes or elbows in the metal pipes, along the entire drainage path. Avoid horizontal sections that cause water stagnation. If an extension is connected to the condensate drain pipe, maintain a slope of  $5^\circ$ .

For the connection proceed as follow:

1.

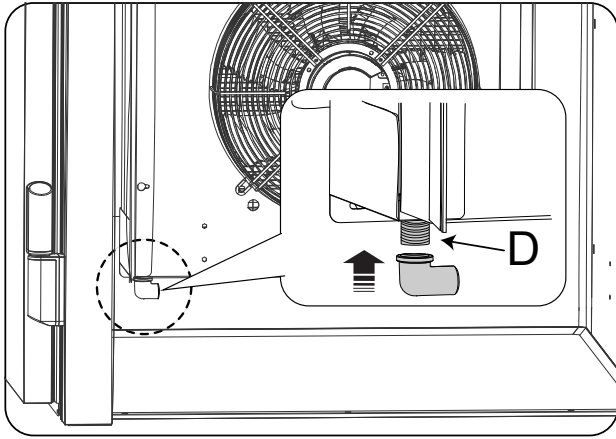

2.



**IMPORTANT**  
Maintain a slope of  $5^\circ$

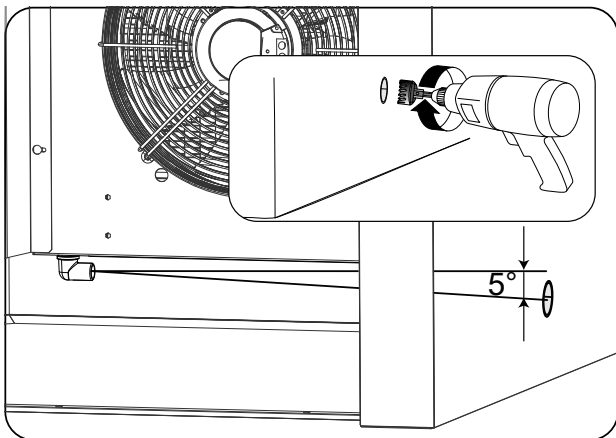

3.

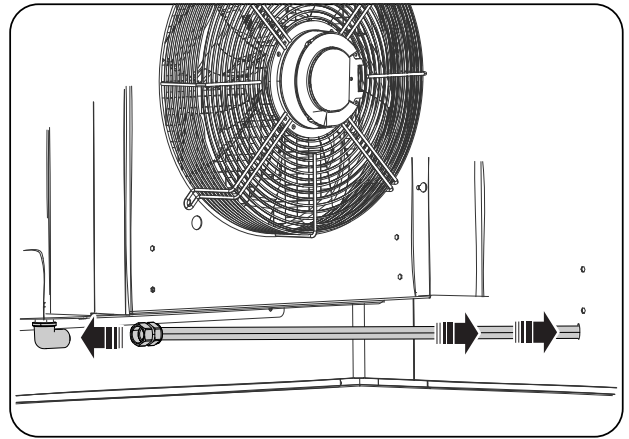

4.

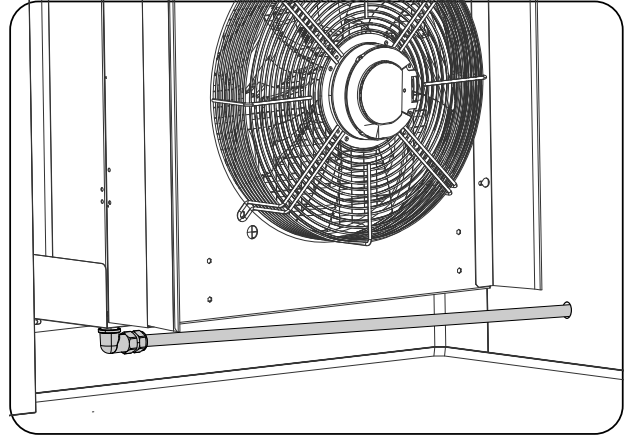



CE

Electrolux Professional SPA  
Viale Treviso 15  
33170 Pordenone  
[www.electroluxprofessional.com](http://www.electroluxprofessional.com)